



Indian Council of Forestry Research and Education

(An Autonomous body of the Ministry of Environment, Forest and Climate Change, Government of India)

P.O. New Forest, Dehradun – 248 006 (Uttarakhand), INDIA

No. 7/2018/ESIP/BCC/ICFRE

Dated: 28/01/2021

Request for Quotations

Sub.: Request for quotation for fencing of the carbon flux tower site along with construction of temporary security hut at carbon flux installation site in Madhya Pradesh

Name of Project: Ecosystem Services Improvement Project

Procurement Reference No.: IN-ICFRE-215710-CW-RFQ

1. The Government of India has received grant from the World Bank towards the cost of the Ecosystem Services Improvement Project (ESIP). Indian Council of Forestry Research and Education (ICFRE) is one of the Project Implementing Agencies and intends to apply the part of proceeds of this grant to eligible payments under the contract for which this Request for Quotations is issued. The procurement process will be conducted in accordance with the Request for quotations (RFQ) procurement method contained in the World Bank Guidelines: Procurement of Goods, Works and Non-consulting Services under IBRD Loans and IDA Credits and Grants by World Bank Borrowers, dated January 2011, revised in July 2014.
2. ICFRE now invites Request for Quotation for fencing of the carbon flux tower site along with construction of temporary security hut at carbon flux installation site at Compartment No. 649, Khatpura beed of Budhni Forest Range, Madhya Pradesh.
3. You are invited to submit your Request for quotation (RFQ) for fencing of the carbon flux tower site along with construction of temporary security hut at carbon flux installation site in Madhya Pradesh under Ecosystem Services Improvement Project as per the format given in Annexure-I.
4. Quoted price will be evaluated and contract will be awarded to the responsive bidder offering the lowest price.
5. Quotation(s) must be marked as "Quotation for fencing of the carbon flux tower site along with construction of temporary security hut at carbon flux installation site in Madhya Pradesh" and addressed to the:
Project Director
Ecosystem Services Improvement Project
Room No: 143
Indian Council for Forestry Research and Education
P. O. New Forest, Dehradun, Uttarakhand-248006 (INDIA)
6. All the registered Civil Contractors of CPWD, PWD, and other Govt. departments are invited to submit sealed Request for quotations for the above-mentioned works.
7. The bidder should submit earnest money deposit of Rs. 25,000/- in the form of Account Payee Demand Draft in the name of ICFRE Security Money/ EMD Account.
8. The work shall be completed within 30 days from the date of award of work.
9. Award of the contract and agreement will be signed between firm and Project Director, ESIP.
10. The schedule of rate of Public Works Department 2020 (MP) shall be applicable.
11. The deadline for receipt of quotation at the address indicated above is by **12 February 2021 at 5:30 hrs.**
12. Quotation should be submitted as per the instructions contained in the Annexure - II of this document.
13. The prices shall be quoted in Indian Rupees and shall be inclusive of GST. No price increase will be allowed after the submission of RFQ.
14. Validity of the Offer: Quotation shall be valid for a period of 90 days from the date for receipt of quotation(s) indicated in Paragraph 7 above.

15. Evaluation of Quotations: Procurement Committee of ESIP, ICFRE will evaluate and compare the quotations which are properly signed and confirm to the terms and conditions and specifications of the RFQ.
16. Award of contract: The contract will be awarded to the Firm(s) whose quotation has been determined to be substantially responsive and has offered the lowest price.
17. Notwithstanding the above, the Project Director, ESIP reserves the right to accept or reject any quotations and to cancel the procurement process and reject all quotations at any time prior to the award of contract.
18. The Firm(s) whose quotation is accepted will be notified for the award of contract prior to expiration of the quotation validity period.
19. Payment to the firm(s) shall be made through RTGS after verification of the work by the authorized civil engineer and successful completion of the works in time.

Yours faithfully,

Project Director
ESIP, ICFRE

Format of Quotation

(on Firm Letter Head)

Date: _____

To

Project Director, Ecosystem Services Improvement Project
Room No: 143
Indian Council for Forestry Research and Education
P. O. New Forest, Dehradun, Uttarakhand-248006 (INDIA)

Sub.: Request for quotation for fencing of the carbon flux tower site along with construction of temporary security hut at carbon flux installation site in Madhya Pradesh

Madam/ Sir,

We offer to execute the works against for fencing of the carbon flux tower site along with construction of temporary security hut at carbon flux installation site at Compartment No. 649, Khatpura Beed of Budhni Forest Range, Madhya Pradesh for Ecosystem Services Improvement Project in accordance with the conditions of contract, as per following quoted price:

(A). Construction of Chain Link Fencing (Inner)					
S.No.	Particular	Quantity	Price Quoted (INR)		
			Unit Price	GST	Total
1	Excavation rock in narrow areas Earth work in excavation by mechanical means (Hydraulic Excavator)/ manual means in foundation trenches or drains (not exceeding 1.5 m in width or 10 sqm on plan) including dressing of sides and ramming of bottoms, lift up to 1.5 m, including getting out the excavated soil and disposal of surplus excavated soil as directed, within a lead of 50 m. (No extra lift is payable if work is done by mechanical means) [For Angle Iron Post 50x50x5x@2.5 m C/C - Fencing (No=14, L=0.45, B=0.45, H/D=0.60, Qty=1.70) Struts (No=8, L=0.70, B=0.50, H/D=0.45, Qty=1.26) Gate column (No=2, L=0.45, B=0.45, H/D=0.70, Qty=0.28)	3.24 Cum			
2	C.C. up to plinth level - Providing and laying in position cement concrete of specified grade excluding the cost of centering and shuttering - All work up to plinth level: With 40mm nominal size graded stone aggregate. 4.1.2.3 - M-7.5 Nominal Mix -1 Cement: 4 sand: 8 graded stone aggregate Fencing (No=14, L=0.45, B=0.45, H/D=0.60, Qty=1.70) Struts (No=8, L=0.70, B=0.50, H/D=0.45, Qty=1.26) Gate column (No=2, L=0.45, B=0.45, H/D=0.70, Qty=0.28)	3.24 Cum			
3	Structural steel work single section - Structural steel work in single section fixed with or without connecting plate including cutting, hoisting, fixing in position and applying a priming coat of approved steel primer all complete. Angle for fencing 50 x 5 - Fencing (No=14, L=2.50, B=3.80, Qty=133.00) Struts (No=8, L=1.90, B=3.80, Qty=57.76) Gate column (No=2, L=2.60, B=4.90, Qty=25.48)	216.24 Kg			
4	Fencing with G.I. chain link fabric 3mm dia - Providing and fixing G.I. chain link fabric fencing of required width in mesh size 25x25 mm made of G.I. wire of dia. 3mm including strengthening with 2mm dia. wire or nuts, bolts and washers as required complete, with posts of specified material and of standard design placed and embedded in cement concrete blocks 45x45x60cm of mix 1:5:10 (1cement :5 sand : 10 graded stone aggregate 40mm nominal size) every 15th post, last but one end post and corner post shall be strutted on both sides and end post on one side only and struts embedded in cement concrete blocks 70x45x50cm of the same mix, as per the direction of Engineer-in-Charge. (cost of post painting earth work & C.C. to be paid separately) 38x1.80 = 68.40	68.40 Sqm			
5	Structural steel work built up sections - Structural steel work using M.S. flats, angles, channels I-section, H-section etc. riveted, bolted or welded in built up sections, trusses and framed work, including cutting, hoisting, fixing in position and applying a priming coat of approved steel primer all complete. Gate - L.S. -	100.00 Kg			

*SOR – Schedule of Rate, *PWD – Public Works Department, *Sqm – Square meter, *Cum – Cubic meter

(B). Construction of Chain Link Fencing (Outer)					
S.No.	Particular	Quantity	Price Quoted (INR)		
			Unit Price	GST	Total
1	Excavation rock in narrow areas Earth work in excavation by mechanical means (Hydraulic Excavator)/ manual means in foundation trenches or drains (not exceeding 1.5 m in width or 10 sqm on plan) including dressing of sides and ramming of bottoms, lift up to 1.5 m, including getting out the excavated soil and disposal of surplus excavated soil as directed, within a lead of 50 m. (No extra lift is payable if work is done by mechanical means) [For Angle Iron Post 50x50x5] - Fencing (No=125, L=0.45, B=0.45, H/D=0.60, Qty=15.18) Struts (No=14, L=0.70, B=0.45, H/D=0.50, Qty=2.20) Gate column (No=2, L=1.50, B=1.50, H/D=1.50, Qty=6.75)	24.13 Cum			
2	C.C. up to plinth level – Providing and laying in position cement concrete of specified grade excluding the cost of centering and shuttering - All work up to plinth level: With 40mm nominal size graded stone aggregate. 4.1.2.3 - M-7.5 Nominal Mix - 1 Cement: 4 sand: 8 graded stone aggregate Post (No=125, L=0.45, B=0.45, H/D=0.60, Qty=15.18) Struts (No=14, L=0.70, B=0.45, H/D=0.50, Qty=2.20) Gate column (No=2, L=1.50, B=1.50, H/D=0.10, Qty=0.45)	17.83 Cum			
3	RCC up to plinth - Providing and laying in position specified grade of reinforced cement concrete (with 20mm nominal size graded stone aggregate) excluding the cost of centering, shuttering, finishing and reinforcement - All work up to plinth level: 5.1.1 - M-20 Grade Concrete Col. - 2x1.50x1.50x0.15 = 0.67 For Gate - 2x0.60x0.60x0.30 = 0.21 2x0.30x0.30x3.35 = 0.60 P.B. - 4x0.23x0.23 = 0.21	1.69 Cum			
4	Supplying at site - 10.29.2 Angle iron post and strut of required size including bottom to be split and bent at right angle in opposite direction for 10 cm length and drilling holes up to 10 mm dia. etc. complete. (cost of earth work in excavation and concrete work in foundation to be paid separately) Angle 50 x 5 - 125x3.00x3.80 = 1425.00 Struts - 14x2.40x3.80 = 127.68	1552.68 Kg			
5	Fencing with G.I. chain link fabric 3mm dia - Providing and fixing G.I. chain link fabric fencing of required width in mesh size 25x25 mm made of G.I. wire of dia. 3mm including strengthening with 2mm dia. wire or nuts, bolts and washers as required complete, with posts of specified material and of standard design placed and embedded in cement concrete blocks 45x45x60cm of mix 1:5:10 (1cement :5 sand : 10 graded stone aggregate 40mm nominal size) every 15th post, last but one end post and corner post shall be strutted on both sides and end post on one side only and struts embedded in cement concrete blocks 70x45x50cm of the same mix, as per the direction of Engineer-in-Charge. (cost of post painting earth work & C.C. to be paid separately) [80x4.00 - 4.60] = 315.40 315.40x2.40 = 756.96	756.96 Sqm			
6	Structural steel work built up sections - Structural steel work using M.S. flats, angles, channels I-section, H-section etc. riveted, bolted or welded in built up sections, trusses and framed work, including cutting, hoisting, fixing in position and applying a priming coat of approved steel primer all complete. Gate - 250.00	250.00 Kg			
7	Reinforcement - Reinforcement for R.C.C. work including straightening, cutting, bending, placing in position and binding including cost of binding wire all wastages and overlaps, couplers (overlaps shall be provided as per requirement of IS 13920 for ductile detailing IS 456 RCC Design & SP 34 Reinforcement detailing) etc. complete. (Note: - 1. Spacer bars (chairs) shall be paid separately as shown in the drawing and as per direction of engineer in charge. 2. No extra payment shall be done for overlaps and/or couplers. 3. Couplers shall be conforming to IS code on "Reinforcement Couplers for Mechanical Splices of Bars for Concrete Reinforcement - Specification") 70 kg / Cum of R.C.C. - 1.69 x 70.00 = 118.30	118.30 Kg			
8	Add for Paintings	-			

*SOR – Schedule of Rate, *PWD – Public Works Department, *Sqm – Square meter, *Cum – Cubic meter

(C). Construction of Security Hut					
S.No.	Particular	Quantity	Price Quoted (INR)		
			Unit Price	GST	Total
1	Earth work in excavation by mechanical means (Hydraulic Excavator)/ manual means in foundation trenches or drains (not exceeding 1.5 m in width or 10 sqm on plan) including dressing of sides and ramming of bottoms, lift up to 1.5 m, including getting out the excavated soil and disposal of surplus excavated soil as directed, within a lead of 50 m. (No extra lift is payable if work is done by mechanical means) All kinds of soil. Room - C.L. - $3.03 \times 2 + 3.58 \times 2.00 = 13.22$ Room - $13.22 \times 0.60 \times 0.75 = 5.95$ Steps - $1.10 \times 0.60 \times 0.30 = 0.19$	6.14 Cum			
2	Providing and laying in position cement concrete of specified grade excluding the cost of centering and shuttering - All work up to plinth level: 4.1.2 With 40mm nominal size graded stone aggregate. 4.1.2.3 Nominal Mix - 1 Cement: 4 sand: 8 graded stone aggregate (M -7.5) Room - $13.22 \times 0.60 \times 0.15 = 1.19$ Under floor - $3.35 \times 2.80 \times 0.10 = 0.94$ Steps - $1.10 \times 0.60 \times 0.10 = 0.06$	2.19 Cum			
3	Brick work with well brunt open bhata, bricks, crushing strength not less than 25kg /cm ² and water absorption not more than 20% in foundation and plinth i/c curing etc. complete. 6.5.2 Cement Mortar 1:6 (1 cement: 6 sand). Room - $13.22 \times 0.34 \times 0.90 = 4.04$ Steps - $1 \times 0.60 \times 0.30 = 0.18$	4.22 Cum			
4	Brick work with well brunt open bhata, bricks, crushing strength not less than 25kg / cm ² and water absorption not more than 20% in superstructure above plinth level and up to floor two level i/c curing etc complete. 6.6.2 Cement Mortar 1:6 (1 cement: 6 sand) Walls - $13.22 \times 0.34 \times 2.90 = 13.03$ Ded. - D - $2 \times 0.90 \times 2.00 \times 0.23 = 0.82$ $1 \times 0.70 \times 1.80 \times 0.23 = 0.29$ W - (-) $1 \times 1.20 \times 1.20 \times 0.23 = 0.33$ V - (-) $1 \times 0.60 \times 0.45 \times 0.23 = 0.06$ Total - $13.03 - 1.50 = 11.53$ Mas. For Parapet - $10.96 \times 0.23 \times 0.30 = 0.75$	12.28 Cum			
5	Providing and laying damp-proof course 40mm thick with cement concrete 1:2:4 (1 cement: 2 sand: 4 graded stone aggregate 12.5mm nominal size). $13.22 \times 0.23 = 3.04$	3.04 Sqm			
6	15 mm cement plaster on the rough side of single or half brick wall of mix: 13.2.2 1:6 (1 cement: 6 sand) Inner - $2 \times 3.35 \times 2.90 = 19.43$ $2 \times 2.80 \times 2.90 = 16.24$ Outer - $2 \times 3.81 \times 3.10 = 23.62$ $2 \times 3.26 \times 3.10 = 20.21$ Parapet - $10.96 \times 0.83 = 9.09$ Ded. - $2 \times 0.90 \times 2.00 = (-) 3.60$ $1 \times 0.70 \times 1.80 = (-) 1.26$ $1 \times 1.20 \times 1.20 = (-) 1.44$ $1 \times 0.60 \times 0.45 = (-) 0.27$	82.02 Sqm			
7	Structural steel work in single section fixed with or without connecting plate including cutting, hoisting, fixing in position and applying a priming coat of approved steel primer all complete Choukhats & Roof - (L - 40x5) - $3 \times 3.50 \times 3.00 = 31.50$ (L - 35x5) D = $5 \times 1.00 = 5.00$ D - $4.30 \times 1.00 = 4.30$ W - $4.80 \times 1.00 = 4.80$ V - $2.10 \times 1.00 = 2.10$ Total - $16.20 @ 2.60 = 42.12$	31.50 Kg 42.12 Kg			
8	Structural steel work built up sections - Structural steel work using M.S. flats, angles, channels I-section, H-section etc. riveted, bolted or welded in built up sections, trusses and framed work, including cutting, hoisting, fixing in position and applying a priming coat of approved steel primer all complete. W - 16.00 V - 5.00	21.00 Kg			
9	Providing and fixing 1mm thick M.S. sheet door with frame of 40x40x5mm angle iron and 3mm M.S. gusset plates at the junctions and corners, all necessary fittings complete, including applying a priming coat of approved steel primer. 10.5.1 Using M.S. angels 40x40x6mm for diagonal braces D - $0.90 \times 2.00 = 1.80$ $0.70 \times 1.80 = 1.26$ W - $1.20 \times 1.20 = 1.44$	4.50 Sqm			

10	Epoxy paint: - Finishing with Epoxy paint (two or more coats) at all locations prepared and applied as per manufacturer's specifications including appropriate priming coat, preparation of surface, etc. complete. 13.56.2 - On concrete work Room - D - $1 \times 0.90 \times 2.00 \times 2.20 = 3.96$ $1 \times 0.70 \times 1.80 \times 2.20 = 2.77$ W - $1 \times 1.20 \times 1.20 \times 2.20 = 3.16$ V - $1 \times 0.60 \times 0.45 = 0.27$	10.16 Sqm			
11	Cement concrete flooring 40mm thick - 40 mm thick Cement concrete flooring 1:2:4 (1 cement: 2 sand: 4 graded stone aggregate) 20mm nominal size stone aggregate in panels finished with a floating coat of neat cement including cement slurry, but excluding the cost of nosing of steps etc. complete. (Area of panel not to exceed 2.0 sqm) Room - $3.35 \times 2.80 = 9.38$ Steps - $1 \times 0.60 = 0.60$	9.98 Sqm			
12	Providing and fixing water closet squatting pan (Indian type W.C. pan) with 100mm sand cast Iron P or S trap, uPVC P or S trap, 10 litre low level white P.V.C. flushing cistern, including flush pipe, with manually controlled device (handle lever) conforming to IS: 7231, with all fittings and fixtures complete including cutting and making good the walls and floors wherever required: 17.1.1 White Vitreous china Orissa pattern W.C. pan of size 580x440mm with integral type foot rests.	1.00 Each			
13	Providing half brick masonry with well burnt open bhata bricks crushing strength not less than 25 kg /cm ² and water absorption not more than 20% in superstructure above plinth level and up to floor two level. 6.14.2 Cement mortar 1:4 (1 cement: 4 sand) $2.70 \times 2.90 = 7.83$	7.83 Sqm			
14	12 mm cement plaster of mix: 13.1.2 1:6 (1 cement: 6 sand) $2 \times 2.70 \times 2.90 = 15.66$	15.66 Sqm			
15	White washing with lime to give an even shade: 13.43.1 New work (three or more coats) As per plaster - $87.02 + 15.66 = 102.68$	102.68 Sqm			
16	Providing corrugated G.S. sheet roofing including vertical/ curved surface fixed with polymer coated J or L hooks, bolts and nuts 8 mm diameter with bitumen and G.I. limpet washers or with G.I. limpet washers filled with white lead and including a coat of approved steel primer and two coats of approved paint on overlapping of sheets complete up to any pitch in horizontal/ vertical or curved surfaces) excluding the cost of purlins, rafters and trusses and including cutting to size and shape wherever required. 12.1.3 0.63 mm thick with zinc coating not less than 275gm/m ² $3.58 \times 3.60 = 12.88$	12.88 Sqm			
17	Extra for providing and fixing wind ties of 40x 6mm flat iron section. $3 \times 3.50 = 10.50$	10.50 Meter			
18	Add for Septic Tank & S.W. Fittings - Sign Board & Figuring -	-			
19	Add. Miscellaneous	-			

*SOR – Schedule of Rate, *PWD – Public Works Department, *Sqm – Square meter, *Cum – Cubic meter

We agree to execute the above-mentioned civil works in accordance with the descriptions/ specifications of the works for a total contract price of Rs. (Rupees.....only) as per the terms and conditions specified in the request for quotation.

We hereby certify that we have taken steps to ensure that no person acting for us on our behalf will engage in bribery.

Authorized Signature with seal:
Name and Title of Signatory:

Figure for (A). Drawing for construction of Inner Fencing

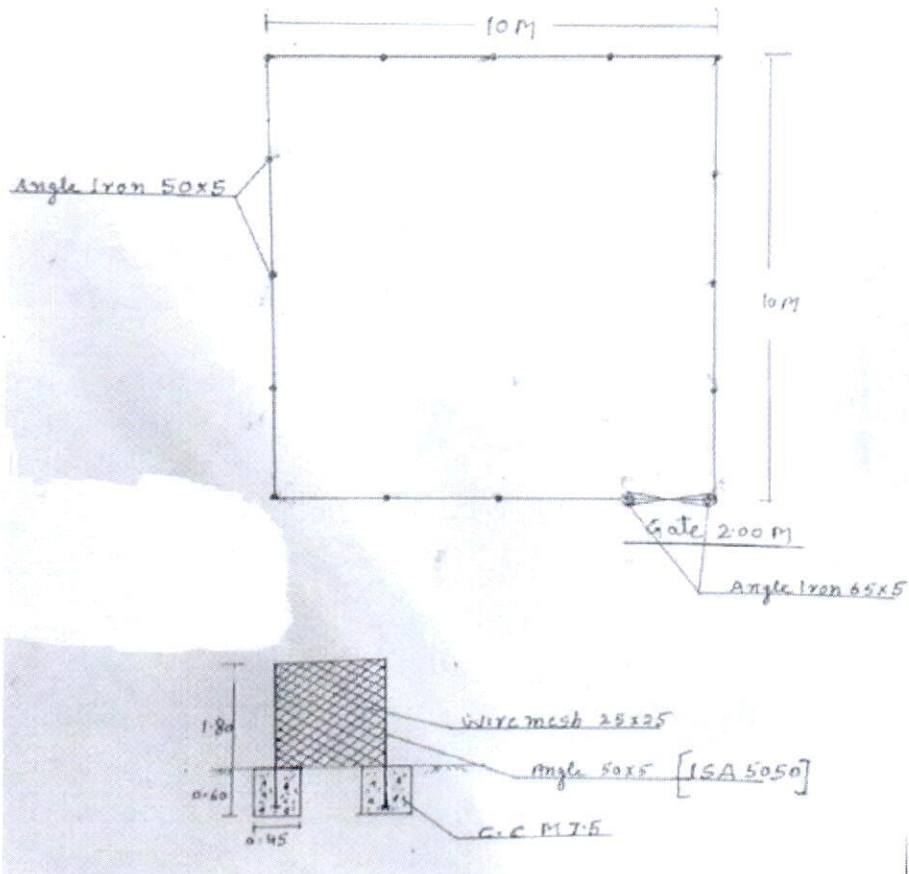

Figure for (B). Drawing for construction of Outer Fencing

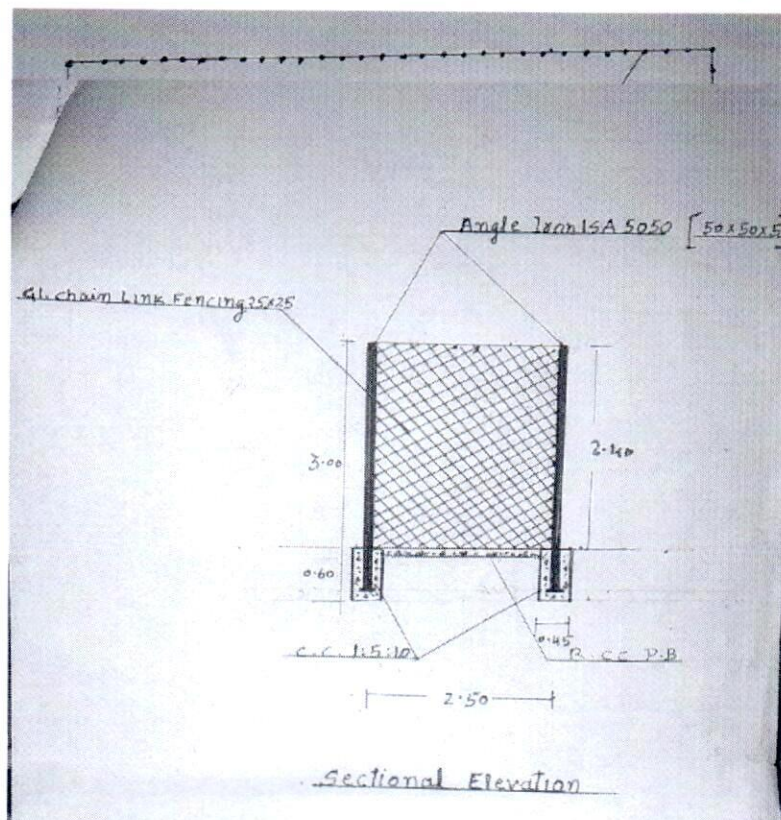
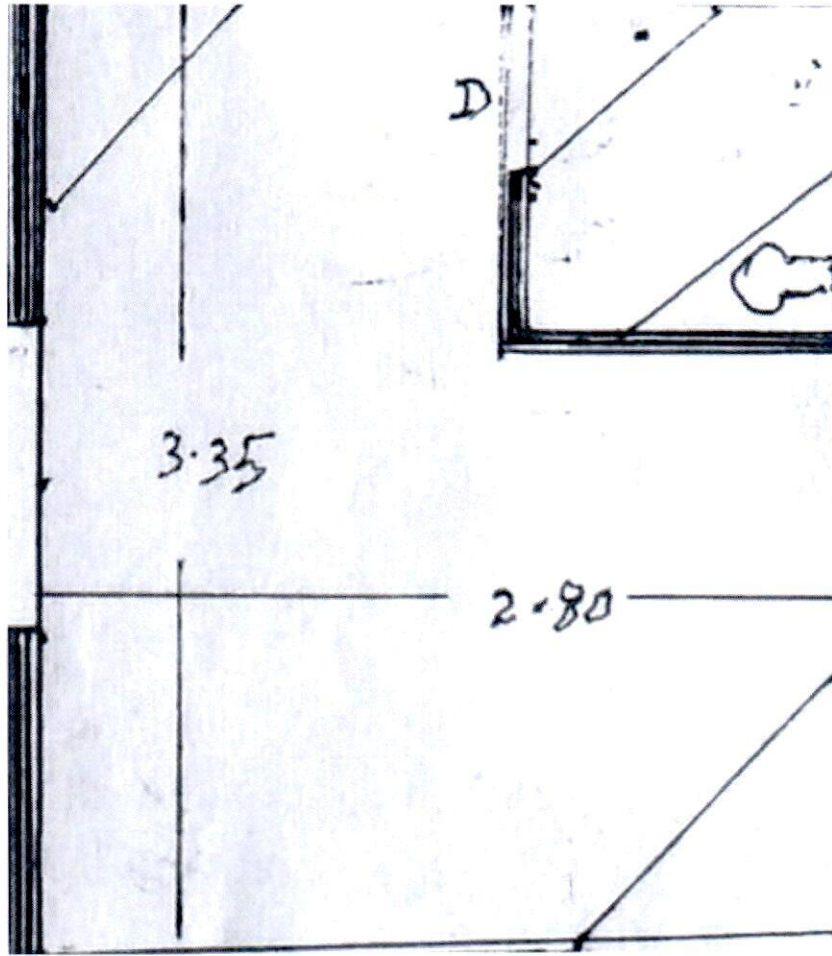

Figure for (C). Drawing for construction of Security Hut



Instructions for Preparing Quotations

1. Scope of Procurement: Invites price against request for quotation for fencing of the carbon flux tower site along with construction of temporary security hut at carbon flux installation site in Madhya Pradesh for Ecosystem Services Improvement Project as described in the Para 2 of Annexure-I.
The successful Contractors/ Firm(s) will be expected to execute civil works in all aspects within contract duration.
2. Eligibility to Quote: To qualify for award of the Contract, a contractor/bidder shall meet the following minimum qualifying criteria:
 - a. Contractors/bidders must be registered with Civil Contractors of CPWD, PWD, other Govt. departments etc. As contractor/bidder must have at least 3-5 years of experience in execution of civil works in the Government Departments. Proof of registration and experience must be provided with the quotation.
 - b. Submit proof of registration with the Income Tax Department and Sales Tax Department/GST with the quotation. (Failure to enclose these documents would result in rejection of quotation).
 - c. Submit only one quotation, either individually, or as a partner in a joint venture. Quotations submitted in violation of this rule shall be rejected. Partners in a joint venture shall be jointly and severally liable for the execution of the contract.
2. Documents to be attached/ enclosed with the Quotation: The proposal submitted by the Firm must be include following documents:
 - a. Quotation on the letter head of Firm (As per sample format attached 'Annexure-I')
 - b. Qualification and Experience Information and other relevant documents
 - c. Copies of registration/taxation documents
 - d. Firm Profile
 - e. Proof of experience for execution of civil works in Government departments/ institutions/ organizations
3. Currency of Quotations:
 - a) Rate inclusive of GST shall be quoted in Indian Rupees.
 - b) The rates and price offered/ quoted by the contractor/bidder shall be fixed for the duration of the Contract and shall not be changed subject to any adjustment on any account.
4. Quotation shall be valid for 90 days from the date for receipt of the quotations.
5. The Project Director, ESIP, ICFRE reserves the right to increase or decrease quantities of the works.
6. Decision of Director General, ICFRE will be final in case of any dispute.
7. For any query/ clarification (if any) regarding request for quotation please contact:

Project Director, Ecosystem Services Improvement Project
Room No: 143
Indian Council for Forestry Research and Education
P. O. New Forest, Dehradun, Uttarakhand-248006 (INDIA)
Phone No. 0135-2224803, 2224823
Email: projectdirectoresip@gmail.com
8. For redressal of the grievance (if any) arising out of the implementation of the activities under Ecosystem Services Improvement Project, can be submitted to grievance redressal committee, ESIP at ICFRE, Dehradun.

Project Director
ESIP, ICFRE, Dehradun